

comfortable

quiet

smooth

*it all
starts
with a
vision*

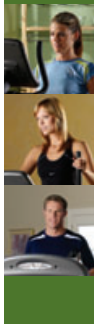

500 South CP Avenue • P.O. Box 280 • Lake Mills, WI 53551
toll free 800.335.4348 • phone 920.648.4090 • fax 920.648.3373
www.visionfitness.com

©2008 Vision Fitness. All Rights Reserved.
May be covered by one or more patents or patents pending: US 4917376
6.08
AG18.43PMD
REV2

ASSEMBLY GUIDE



R2050
STEP-THRU
SEMI-RECLUMBENT
FITNESS BIKE



TOOLS & PARTS INCLUDED

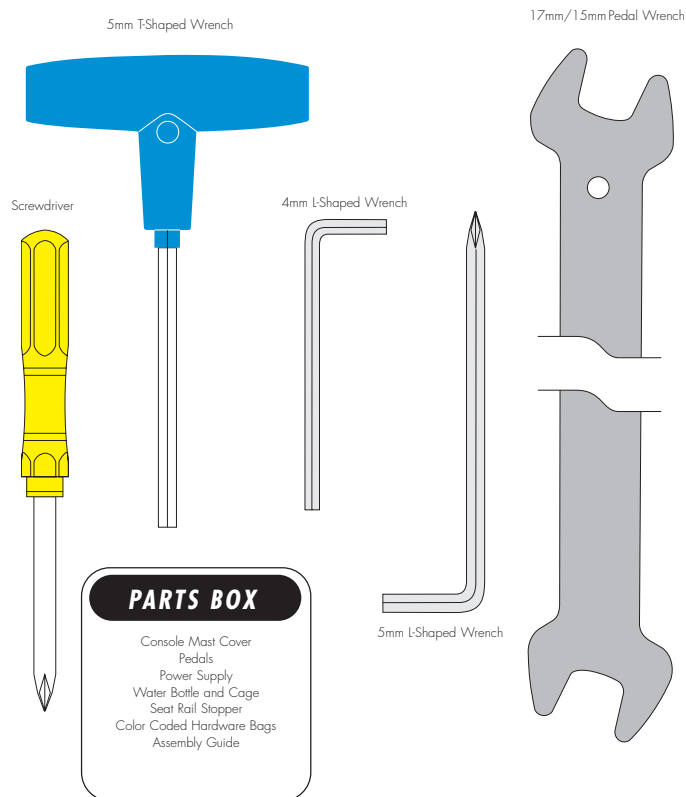

HARDWARE INCLUDED

ORANGE BAG



M8 x 20L Bolt
Quantity: 2



SW8 Lock Washer
Quantity: 4

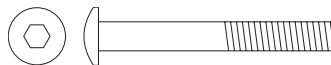

M8 x 65L Bolt
Quantity: 2

BLUE BAG



M8 x 15L Bolt
Quantity: 4



SW8 Lock Washer
Quantity: 4

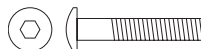

M6 x 35L Bolt
Quantity: 8



M6 Arc Washer
Quantity: 8

PINK BAG



M8 x 10L Set Screw
Quantity: 1



SW8 Lock Washer
Quantity: 6



M8 x 15L Bolt
Quantity: 4



M8 x 20L Bolt
Quantity: 2

BLACK BAG

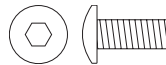

M8 x 20L Bolt
Quantity: 2



Seat Rail Stopper
(Illustration not to scale)
Quantity: 1

Assembly Guide

R2050

STEP-THRU SEMI-RECLUBENT FITNESS BIKE

To avoid possible damage to this Fitness Bike, please follow these assembly steps in the correct order. Before proceeding, find your new Fitness Bike's serial number located on the front axle tube, and enter here:

Refer to this number when calling for service, and enter this serial number on your Warranty Card and in your own records. Be sure to read your Owner's Guide before using your new Fitness Bike.

If any parts, hardware or tools are missing, please call 1.800.335.4348

NOTE: It is recommended that you apply grease to the threads of each bolt and screw as you assemble your Fitness Bike to prevent loosening and noise. Also, during each assembly step, ensure that ALL bolts and screws are in place and partially threaded in before completely tightening any ONE bolt or screw.

STEP 1 ORANGE BAG

- Slide the Rear Foot into place on the back end of the frame. Secure the foot in place to the frame with two bolts (M8x20L) and two lock washers (SVB8) to the outside holes and with two bolts (M8x6SL) and two lock washers (SVB8) to the inside holes. Tighten with the 5mm THandle Wrench.

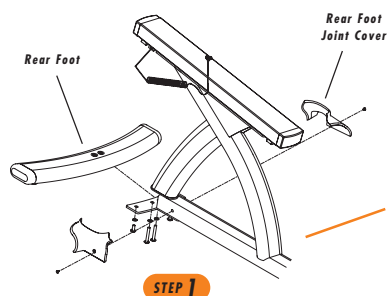

STEP 2 BLUE BAG

- Rotate the handle on the seat rail to the forward most position. Tighten the adjustment bolt on the seat frame bracket with the 5mm TShaped wrench.
- Slide the seat frame onto the seat rail.
- Attach the seat rail stopper onto the seat rail with two (M8x20L) bolts and two lock washers (SVB8). Tighten with the 5mm THandle wrench. **NOTE:** The seat rail stopper and bolts are in a separate bag.
- Connect the heart rate wires in the seat handlebar to the heart rate wires coming up from the seat frame.
- Mount the seat handlebars to the seat frame with four bolts (M8x15L) and four lock washers (SVB8). Tighten with the 5mm THandle wrench.
- Mount the seat bottom cushion to the seat frame with four bolts (M6x35L) and four arc washers (V6). Tighten with the 4mm Tshaped wrench.
- Mount the seatback cushion to the seat frame with four bolts (M6x35L) and four arc washers (V6). Tighten with the 4mm Tshaped wrench.

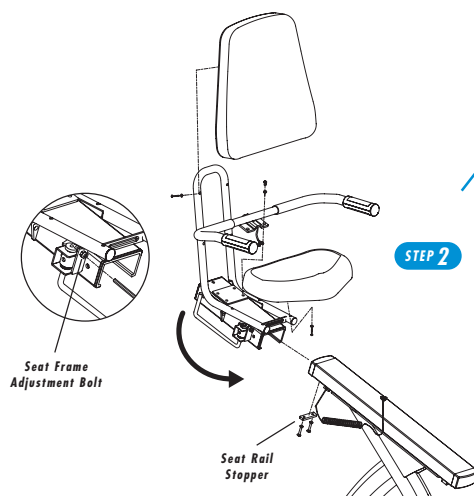

STEP 4

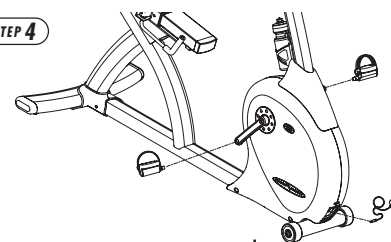

STEP 3

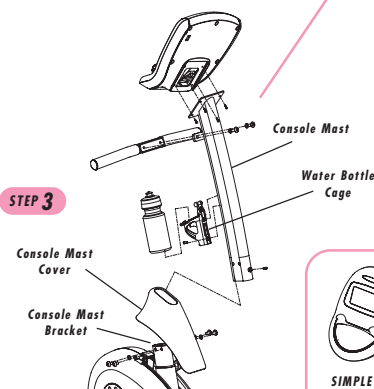

STEP 3

PINK BAG

- Slide the console mast cover onto the console mast.
- Take the wire tie that exits the bottom of the console mast and wrap it around the wire harness and heart rate wires that are sitting in the console mast bracket on the frame. Pull the wire tie up through the top of the console mast so that the wire harness and heart rate wires exit the top of the mast.
- Slide the bottom of the console mast over the frame bracket being careful not to pinch the heart rate wires or wire harness. Assume the mast is positioned correctly by inserting the Set Screw (M8x10L) through the front edge of the mast. Tighten with the 5mm THandle wrench. Secure the mast to the frame with four bolts (M8x15L) and four lock washers (SVB8). Tighten with the 5mm THandle wrench.
- Slide the console mast cover down so it sits on the frame covers.
- Mount the console mast handlebar to the console mast with two bolts (M8x20L) and two lock washers (SVB8). Tighten with the 5mm THandle wrench.
- With the screwdriver remove the four bolts on the back side of the console. Plug in the wire harness and heart rate wires to the back side of the console. Mount the console to the console mast with the four bolts and screwdriver.
- Remove the water bottle cage bolts from the backside of the console mast. Mount the water bottle cage to the mast with these two bolts and the screwdriver.

STEP 4

PEDALS

- Attach the left and right pedals to the left and right crank arms. **NOTE:** both pedals and crank arms should be labeled left or right. Tighten with the included pedal wrench.
- Plug in the power supply to the power socket on the front side of the bike.

STEP 5

CONSOLE

- Refer to Product Selection and Model Configuration decal on console or follow these steps.
- Once the product is plugged in turn on the console.
- Select product [Bike (BK) or Elliptical (EP)] using the resistance arrow keys. Press ENTER to select.
- Select model number [Bike (1500, 2050, 2250, 3200) or Elliptical (1500, 6000, 6200)] using the RESISTANCE arrow keys. Press ENTER to select. Console will reset to startup screen.
- The product selection and model configuration is now complete.

